

Warranty info:

| | |
|--------------------|--------|
| Shower Rail | 1 year |
| Airstream™ Handset | 5 year |

Proof of purchase will be required

The guarantee does not cover faults or damage caused by incorrect installation and/or maintenance, ordinary wear and tear, water composition etc.

METHVEN

Easy Fit Shower Rail Installation Instructions & Maintenance Guide

Product Codes:

EKIT01/A
EKIT02/A
EKIT03/A
EFSR005

Your product has a high quality finish and should be treated with care to preserve the visible surfaces.

Never use abrasives or abrasive cleaning agents to clean this product. Clean regularly with contamination free warm soapy water and a damp soft cloth. Do not use products containing chlorine bleach or hydrochloric acid as these can damage the product. Always rinse the product thoroughly after cleaning to remove cleaning products that can damage the shower.

METHVEN UK LIMITED
METHVEN EXPERIENCE CENTRE
3/3A STONE CROSS COURT
YEW TREE WAY
GOLBORNE
WARRINGTON
WA3 3JD
UNITED KINGDOM

TEL: 0800 195 1602
FAX: +44 (0) 8444 068 690
E: sales@uk.methven.com
methven.com



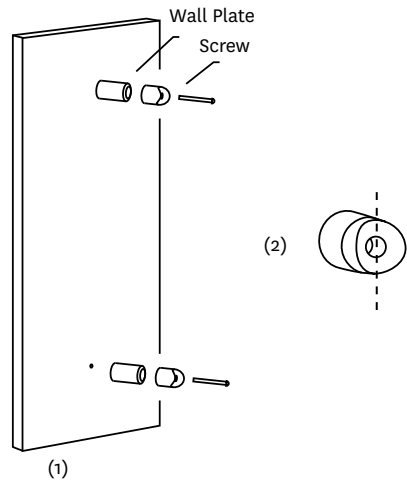

Use a 6mm drill bit to drill a hole in the wall at the desired height, drill a second hole vertically lower at a recommended height of 550mm. In certain situations, the hole may need to be further away to a maximum of 615mm. Place wall plugs into hole and push firmly into place. Place fixing bracket over the wall plugs (1) and insert screw provided, tighten until secure, repeat for second fixing bracket. Push rubber grip into fixing bracket aligning the groove vertically (2)

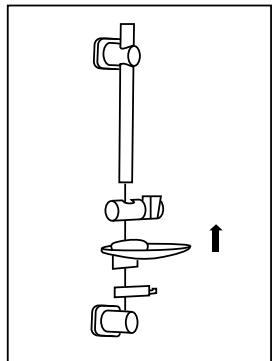

Assemble the handset slider, soap dish and hose retainer on to the rail ensuring button is facing upward (EKIT01/A Lever will face down). Attach both rail end assemblies.

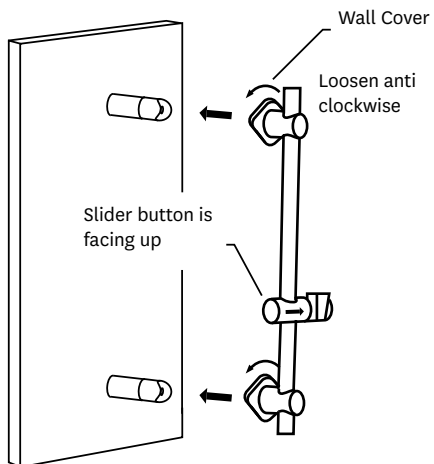

Ensuring the handset slider button is facing upwards (EKIT01/A Lever will face down) as shown in the illustration, adjust the two rail end assemblies to match the position of the wall brackets and turn wall covers anticlockwise to the unlock position.

Locking direction

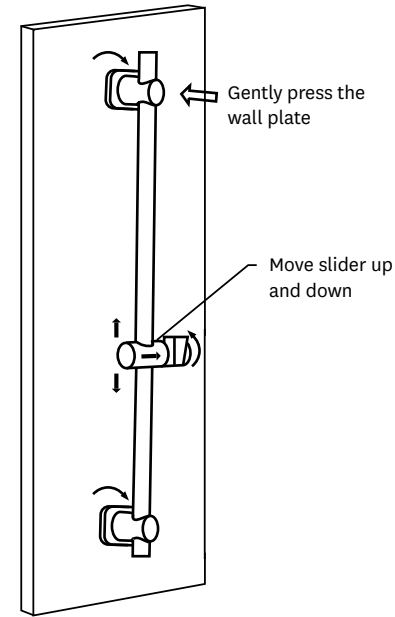

Gently press the rail end assemblies onto the wall brackets, until the rail ends touch the wall. Turn both wall covers clockwise into the locking position, securing the rail. Adjust handset slider to desired height for showing.

Insert flat washer into the shower hose before screwing to the handset. Connect the other end of the shower to the shower outlet.

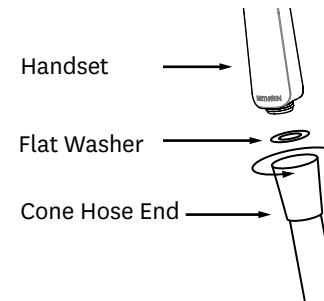

Place the handset securely into the handset slider, and turn shower mixer into the on position and check for leaks.